

1254

TWELVE FIFTY FOUR INDUSTRIES

CONTROL KEYPAD 12FX-LSLV-ACC-CKP

Product Description

The feature rich lighting controller has been designed to provide a control solution for the most demanding of projects, whilst maintaining an easy to use panel of touch sensitive buttons. The controller integrates a graphical color screen allowing scene photos to be displayed. Easily view the selected zone, scene name and design without the need to navigate through complex menus. Change the speed, color and dimmer using the circular palette. The lighting levels, color and effects can be programmed from a PC, Mac, Android, iPad or iPhone using the included software.

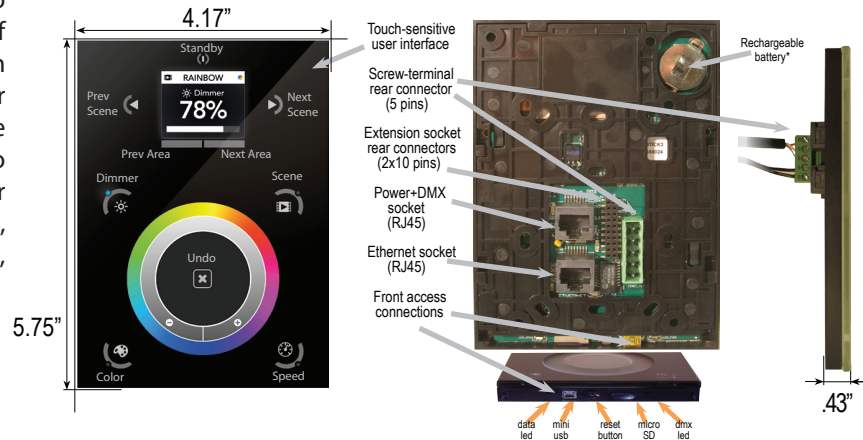

Features & Benefits

- » Graphical color display to show selected environment
- » Color/dimmer/speed palette
- » Color temperature mixing
- » Touch sensitive wheel allows for accurate color selection
- » Multi-zone microSD memory
- » Multi-room control with 500 scenes, 10 zones
- » 1024 DMX channels. Control 340 RGB fixtures
- » USB & Ethernet connectivity for programming and control
- » Clock & Calendar with Sunrise/ Sunset triggering
- » Network Connection. Control lighting remotely
- » Windows/ Mac Software to set dynamic colors/ effect
- » iPhone/iPad/ Android remote and programming apps

Specifications

- » **Input Power:** 6-4V DC 0.6A
- » **Output Protocol:** DMX512 (X2)
- » **Available Colors:** Black & White
- » **Programability:** PC, MAC, Tablet, Smartphone
- » **Connections:** USB, Ethernet, RS232, Clock, 8 dry contact ports, 5v output Relay
- » **Memory:** microSD (32Gb Max)
- » **Temperature:** -10°C-45°C
- » **Mounting:** Single or double gang wall socket

Certifications

EC, EMC, ROHS, ETL

Ordering Information

EXAMPLE: 12FX-LSLV-140-B

12FX-LSLV-140 - _____
2

1. Product Series
Control Keypad
12FX-LSLV-140-

Color
B: Black
W: White